

Φ 80mm ,30-60 Ncm , 200W
 Weight : 2.5 Kg/pcs
 With encoder/brake available
 Front Cover : Square/Circle

M7165

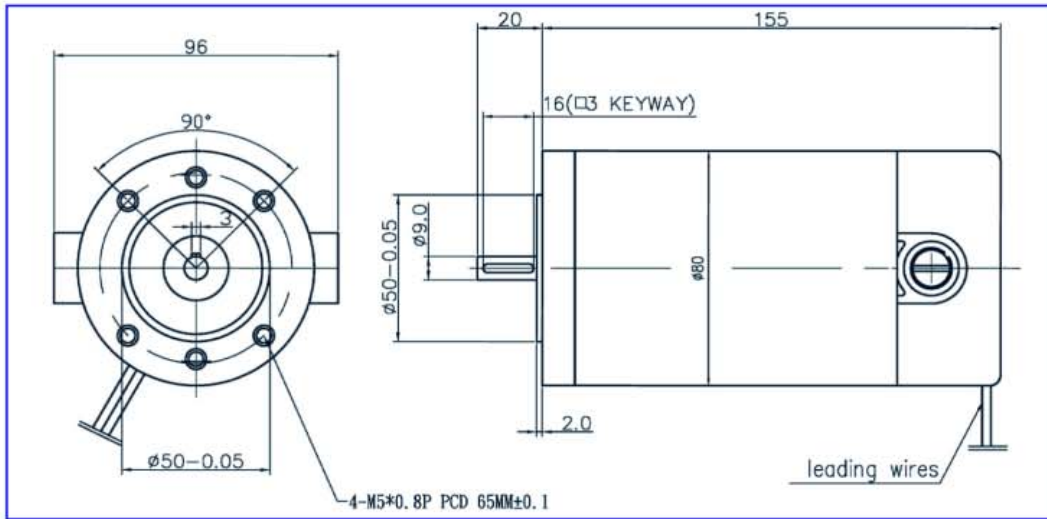

24VDC No Load 2900rpm Torque/Speed Performance Curve

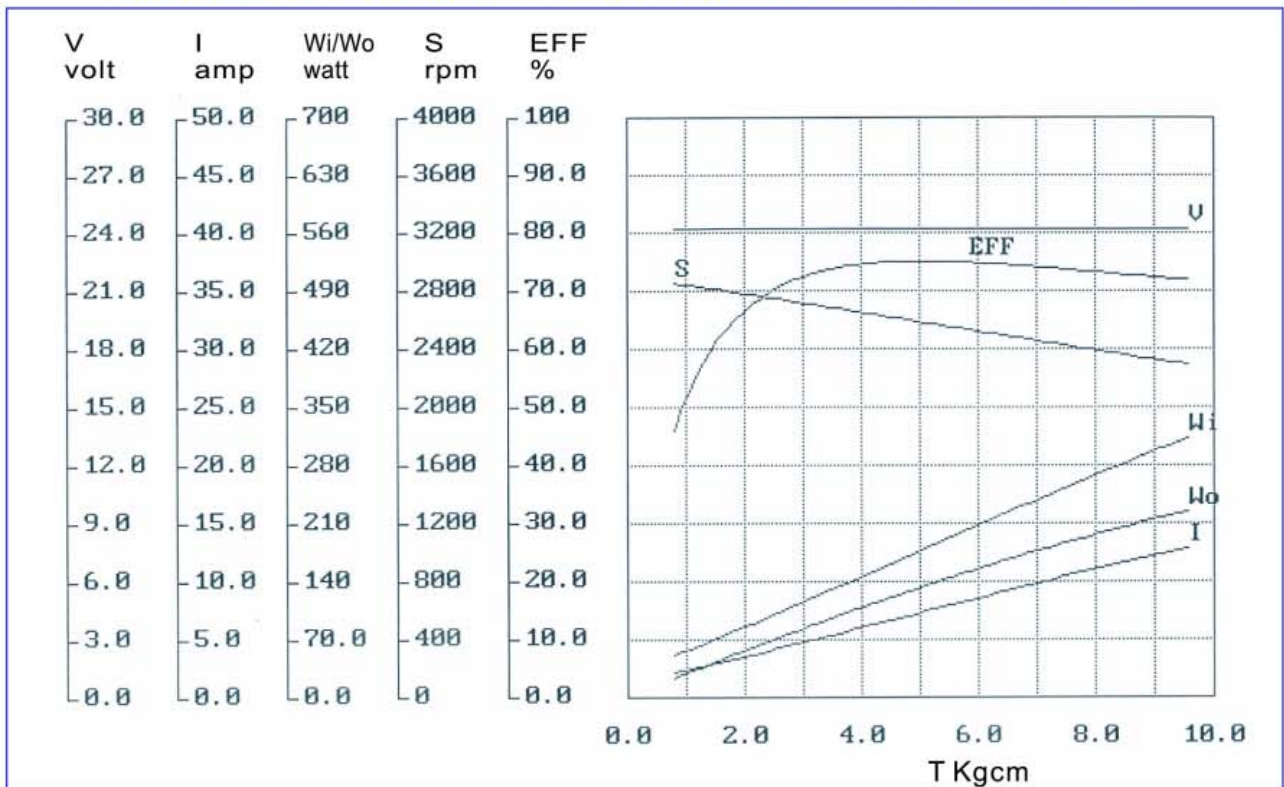

NO	R.P.M.	VOLT(V)	I(AMP)	INPUT(W)	TORQUE(KG-CM)	OUTPUT(W)	EFF(%)
1	2852	24.18	2.11	51.0	0.80	23.4	45.9
2	2789	24.13	3.39	81.8	1.90	54.4	66.5
3	2699	24.15	4.98	120.3	3.10	85.8	71.3
4	2636	24.23	6.36	154.1	4.30	116.3	75.5
5	2563	24.21	7.77	188.1	5.40	142.0	75.5
6	2489	24.21	9.23	223.5	6.50	166.0	74.3
7	2407	24.21	10.74	260.0	7.70	190.2	73.2
8	2335	24.20	12.09	292.6	8.90	213.2	72.9
9	2283	24.23	13.10	317.4	9.70	227.2	71.6